

REGIONAL DISTRICT OF CENTRAL OKANAGAN

BYLAW NO. 683

A bylaw to establish a local service within a portion of Electoral Area "G" to provide for sewer works to the Industrial Park Area.

WHEREAS a regional district may, by bylaw, establish and operate a local service under the provisions of Part 24 of the Municipal Act;

AND WHEREAS the Regional Board of the Regional District of Central Okanagan wishes to establish a local service for the purpose of providing sewer service to a portion of Electoral Area "G";

AND WHEREAS the Regional District of Central Okanagan has an approved Liquid Waste Management Plan;

AND WHEREAS the Regional Board of the Regional District of Central Okanagan waives the assent of the electorate in accordance with Part 3, Section 16, Subsection 10 of the Waste Management Act;

AND WHEREAS the Director of Electoral Area "G" has consented to the establishment of the local service area;

AND WHEREAS the Regional Board of the Regional District of Central Okanagan wishes to provide owners of properties within the proposed Sewer System Local Service Area 303 - Mt. Boucherie the opportunity to pay the total per parcel capital cost prior to preparation of the first annual requisition for the service;

NOW THEREFORE THE REGIONAL BOARD OF THE REGIONAL DISTRICT OF CENTRAL OKANAGAN IN OPEN MEETING ASSEMBLED ENACTS AS FOLLOWS:

1. The Regional District hereby establishes within Electoral Area "G", a local service for the purpose of providing Sewer Service and to be known as the "Sewer System Local Service Area 303 - Mt. Boucherie".
2. The participants in the local service, established under Section 1, are portions of Electoral Area "G" as shown outlined on Schedule "A" attached hereto and forming part of the Bylaw.
3. The annual costs for the service established in Section 1 shall be recovered by:
 - a) The requisition of money under Section 809.1 to be collected by a parcel tax to be imposed in the manner provided by Section 810.1 (2).
 - b) The imposition of fees and other charges that may be fixed by a separate bylaw for the purpose of recovering these costs.
4. The Regional Board may, by separate bylaw, provide that the parcel tax imposition under Section 810.1(2) may be commuted for payment in cash under the terms and conditions set under that bylaw.
5. The maximum amount that may be requisitioned annually under Section 804(1) (b) for costs of the service shall be \$105,000.
6. This bylaw may be cited as "Regional District of Central Okanagan Sewer System Local Service Area 303 - Mt. Boucherie Establishment Bylaw No. 683, 1996".

READ A FIRST TIME THIS 27th DAY OF May, 1996.

READ A SECOND TIME THIS 27th DAY OF May, 1996.

READ A THIRD TIME THIS 27th DAY OF May, 1996.

Approved by the Inspector of Municipalities this 27th day of June, 1996.

RECONSIDERED AND ADOPTED THIS 8th DAY OF July, 1996.

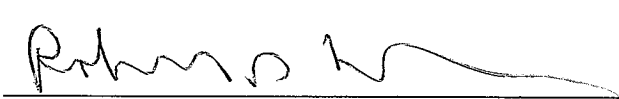

CHAIRPERSON

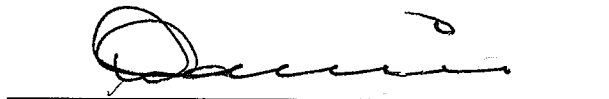

SECRETARY

I hereby certify the foregoing to be a true and correct copy of Bylaw No. 683 cited as the "Regional District of Central Okanagan Sewer System Local Service Area 303 - Mt. Boucherie Establishment Bylaw No. 683, 1996", as read a third time by the Regional Board on the 27th day of May, 1996.

Dated at Kelowna, B.C. this 3rd day of June, 1996.

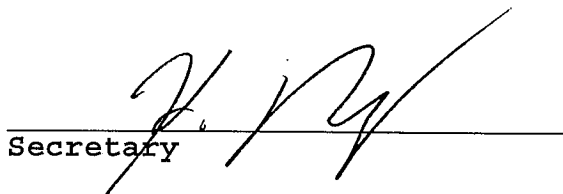
Secretary

I hereby certify the foregoing to be a true and correct copy of Bylaw No. 683 cited as the "Regional District of Central Okanagan Sewer System Local Service Area 303 - Mt. Boucherie Establishment Bylaw No. 683, 1996", as adopted by the Regional Board on the 8th day of July, 1996.

Dated at Kelowna, B.C. this 23rd day of July, 1996.

Secretary

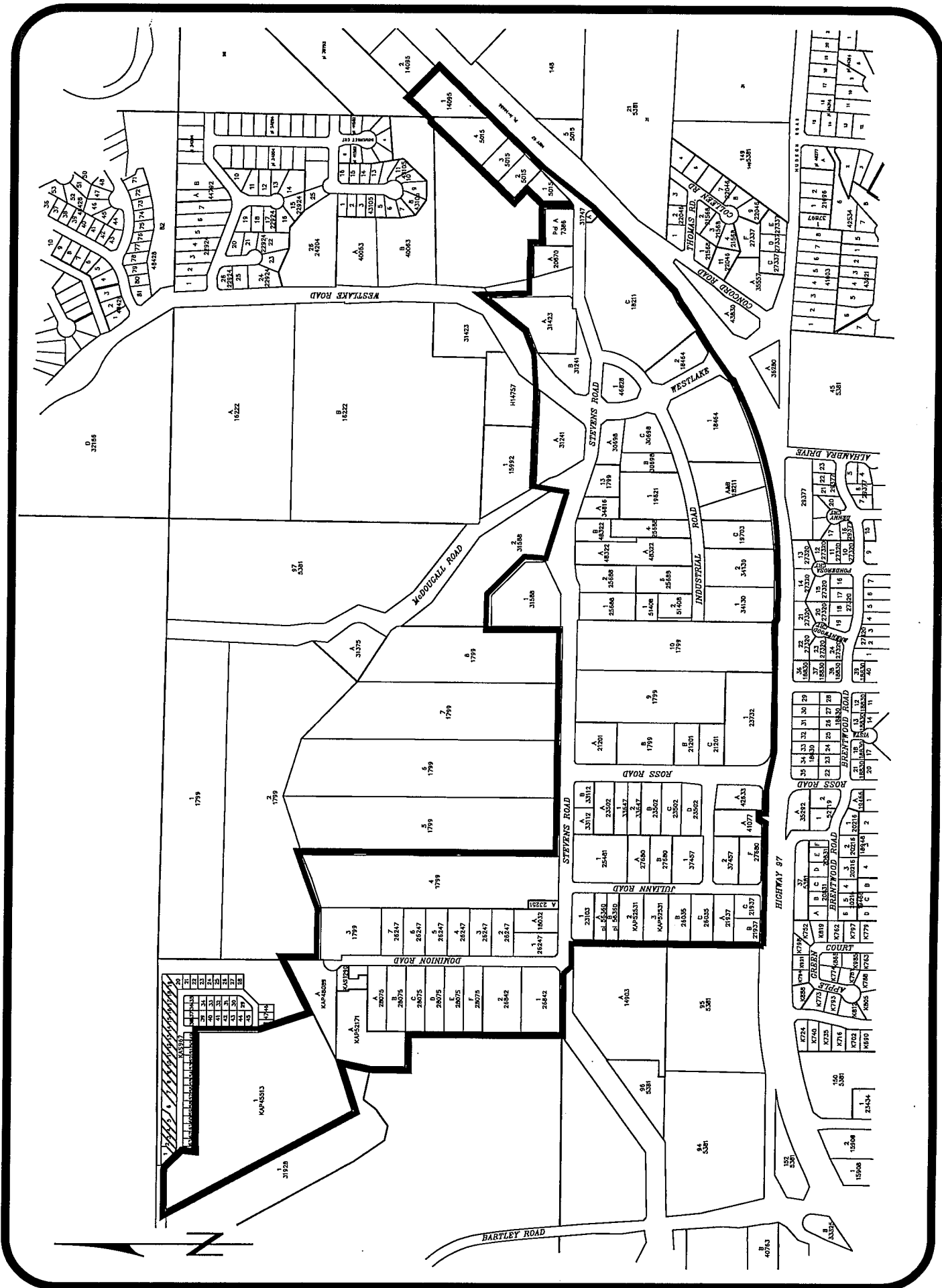

REGIONAL DISTRICT of CENTRAL OKANAGAN
SEWER SYSTEM LOCAL SERVICE AREA 303 – MT. BOUCHERIE
ESTABLISHMENT BYLAW No. 683, 1996
SCHEDULE "A"

REVISIONS :

DATE	BYLAW NO.	DATE	BYLAW NO.

SCALE : 1:10,000

FILENAME : Bylaw 683.dwg

DATE OF ADOPTION : July 8, 1996